

Powerpole® pin & socket series connector, designed as ground terminal are for make-first/break-last connections.

The dovetail feature allows you to interlock multiple housings into vertical and horizontal configurations, providing you with unique variations that are specific to each individual project requirement.

Powerpole® connectors provide 600 Volts continuous, AC or DC operation. This series accommodates #10 AWG (3.3 mm).

### FEATURES

- **Make-first/Break-last connection**

*Provides safety and system integrity*

- **Green housing**

*Indicates ground terminal*

- **Molded-in dovetails**

*Can be assembled into "keyed" configurations to preclude misconnections*

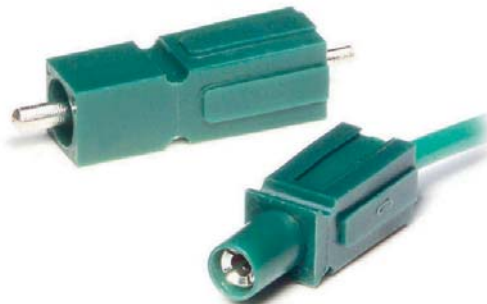

### PRODUCT SPECIFICATIONS

| Connector Model                                    | PP30P&S | Connector Model                         | PP30P&S      |
|--|---------|---|--------------|
| UL Current Rating (Amperes)*                       | 30****  | No load (Contact/Disconnect Cycles)     | To 250       |
| UL Voltage Ratings (Volts)**                       | 600*    | Avg. Connection/Disconnect (lbs)        | 3            |
| Contact Barrel Wire Size (AWG)                     | #10     | Operating Temperature Range °C***       | -20° to 105° |
| (mm <sup>2</sup> )                                 | 5.3     | Flammability Rating of Housing Material | UL94 V-0     |
| Maximum Wire Insulation Diameter (inches)          | 0.175   |   |              |
| (mm)   | 4.45    |   |              |
| AVG Contact Resistance* (micro-ohms)               | 600     |   |              |
| Insulation Withstanding Test Voltage (Volts AC/DC) | 2200    |   |              |
| Contact Retention Force (lbs)                      | 25      |   |              |

\* UL Rated for 65°C rated wire or cable size  
 \*\* Both AC & DC Voltage  
 \*\*\* Contact factory for higher temperature rated connectors  
 \*\*\*\* Based on 10 AWG

### ORDERING INFORMATION

#### 30 amp Ground Socket Connectors

| Part Number | Description                  | Wire AWG | mm  |
|-------------|------------------------------|----------|-----|
| PP30MF-S10T | Make First-Socket-Tin        | #10      | 3.3 |
| PP30MF-S10S | Make First-Socket-Silver     | #10      | 3.3 |
| PP30MF-SPCT | Make First-Socket PC-Pin-Tin | NA       | NA  |
| PP30MF-SPCS | Make First-Socket PC-Silver  | NA       | NA  |

#### 30 amp Ground Pin Connectors

| Part Number | Description              | Wire AWG | mm  |
|-------------|--------------------------|----------|-----|
| PP30MF-P10T | Make First-Pin-Tin       | #10      | 3.3 |
| PP30MF-P10S | Make First-Pin-Silver    | #10      | 3.3 |
| PP30MF-PPCT | Make First-Pin PC-Tin    | NA       | NA  |
| PP30MF-PPCS | Make First-Pin PC-Silver | NA       | NA  |

#### Ground Pin Contacts

| Part Number | Description                    | Dia. |
|-------------|--------------------------------|------|
| 1230G1      | Individual-Pin for wire-Tin    | .134 |
| 1231G1      | Individual-Pin for wire-Silver | .134 |
| 1234G1      | Pin-PCB-Tin                    |      |
| 1235G1      | Pin-PCB-Silver                 |      |

#### Ground Socket Contacts

| Part Number | Description                       | Dia. |
|-------------|-----------------------------------|------|
| 1232G1      | Individual-Socket for wire-Tin    | .134 |
| 1233G1      | Individual-Socket for wire-Silver | .134 |
| 1236G1      | Socket-PCB-Tin                    |      |
| i237G1      | Socket-PCB-Silver                 |      |

#### Pin & Socket Housing Only

| Part Number | Description          |
|-------------|----------------------|
| PP30GND-P   | Pin housing-green    |
| PP30GND-S   | Socket housing-green |

#### Pin & Socket Contacts For Use With Superflex Wire

| Part Number | Description    | Wire AWG | mm |
|-------------|----------------|----------|----|
| 1226G1      | Pin Contact    | #10      | 6  |
| 1228G1      | Socket Contact | #10      | 6  |

#### Tooling

| Part Number | Description    |
|-------------|----------------|
| 1396G1      | Hand Tool      |
| 1387G1      | Pneumatic Tool |
| 1388G8      | - Die #10      |
| 1389G8      | - Locator #10  |

## DIMENSIONS

### Housings

| Series      | -A- |     | -B- |     | -C-  |     | -D-  |      |
|-------------|-----|-----|-----|-----|------|-----|------|------|
|             | mm  | in. | mm  | in. | mm   | in. | mm   | in.  |
| PP30-Pin    | 7.9 | .32 | 7.9 | .32 | 26.6 | .97 | 41.3 | 1.63 |
| PP30-Socket | 7.9 | .32 | 7.9 | .32 | 26.6 | .97 | 41.3 | 1.63 |

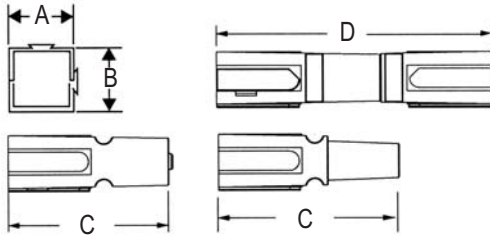

### Contacts

| Series      | -A-  |      | -B-   |       | -C-  |      |
|-------------|------|------|-------|-------|------|------|
|             | mm   | in.  | mm    | in.   | mm   | in.  |
| PP30-Pin    | 5.08 | .200 | 29.22 | 1.150 | 2.29 | .090 |
| PP30-Socket | 5.08 | .200 | 23.71 | .933  | N/A  |      |

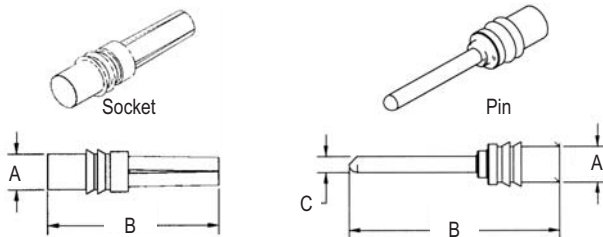

## TEMPERATURE RISE CHART

