

Three Row Cable Connector (female)

TEMPERATURE RISE CHARTS CHARTSCONNECTOR

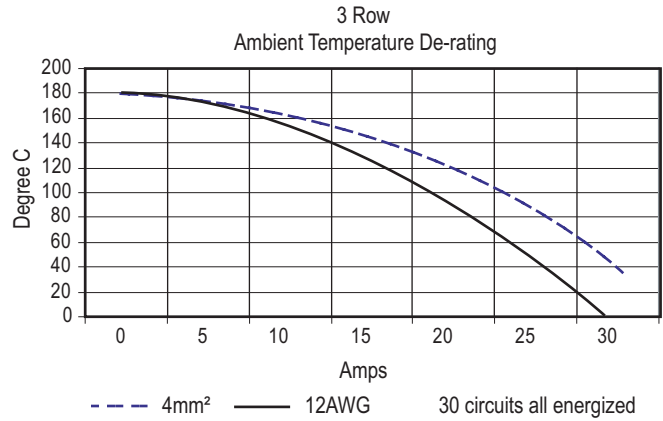
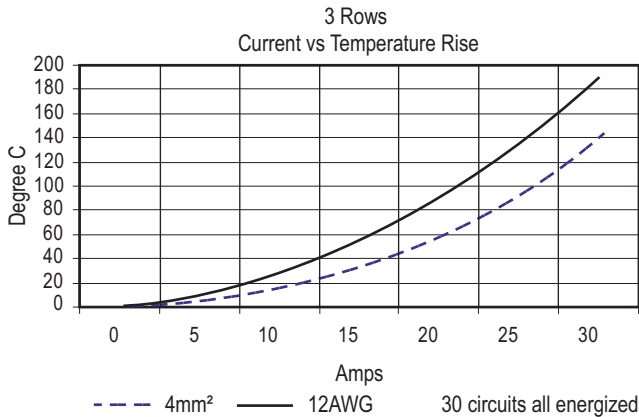

DIMENSIONS

Cable Connector

ROWS CONTACTS	A
3 - 09	28.5
3 - 12	33.5
3 - 18	43.5
3 - 24	53.5
3 - 30	63.5

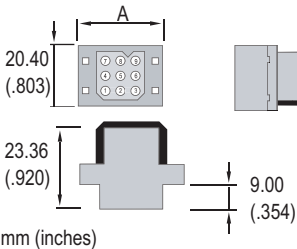

Panel/Mount With Screws

ROWS CONTACTS	S1	S2	S3
3 - 09	16.1	22.3	21
3 - 12	21.1	27.3	21
3 - 18	31.1	37.3	21
3 - 24	41.1	47.3	21
3 - 30	51.1	57.3	21

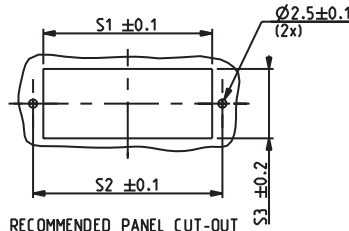

Snap-in Panel Clip

ROWS CONTACTS	P1	P2	P3
3 - 09	29.7	20.8	40.7
3 - 12	34.7	20.8	45.7
3 - 18	44.7	20.8	55.7
3 - 24	54.7	20.8	65.7
3 - 30	64.7	20.8	75.7

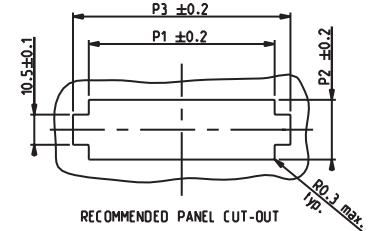

ORDERING INFORMATION

Cable Connector

Part Number	Description
PM309FOOLOO	3x9 FEMALE cable connector
PM312FOOLOO	3x12 FEMALE cable connector
PM318FOOLOO	3x18 FEMALE cable connector
PM324FOOLOO	3x24 FEMALE cable connector
PM330FOOLOO	3x30 FEMALE cable connector

With Snap-in Panel Clip

Part Number	Description
PM309FOOLPC	3x9 FEMALE cable connector
PM312FOOLPC	3x12 FEMALE cable connector
PM318FOOLPC	3x18 FEMALE cable connector
PM324FOOLPC	3x24 FEMALE cable connector
PM330FOOLPC	3x30 FEMALE cable connector

Panel Mount With Screws

Part Number	Description
PM309FOOLSC	3x9 FEMALE cable connector
PM312FOOLSC	3x12 FEMALE cable connector
PM318FOOLSC	3x18 FEMALE cable connector
PM324FOOLSC	3x24 FEMALE cable connector
PM330FOOLSC	3X30 FEMALE cable connector

With Clam Shell Hood & Strain Relief

Part Number	Description
PM309FOOLCH	3x9 FEMALE cable connector
PM312FOOLCH	3x12 FEMALE cable connector
PM318FOOLCH	3x18 FEMALE cable connector
PM324FOOLCH	3x24 FEMALE cable connector
PM330FOOLCH	3x30 FEMALE cable connector

HEADQUARTERS: 13 Pratts Junction Road, P.O. Box 579, Sterling, MA 01564 T:978-422-3600 F:978-422-3700

EUROPE: Rathealy Road, Fermoy Co. Cork, Ireland T:353-(0)25-32277 F:353-(0)25-32296

ASIA/PACIFIC: IDEAL Anderson Asia Pacific Ltd., Unit 922-928 Topsail Plaza, 11 On Sum Street, Shatin N.T., Hong Kong T:852-2636-0836 F:852-2635-9036

www.andersonpower.com

Three Row Right Angle PCB (female)

DIMENSIONS

PCB 3 - row right angle connector

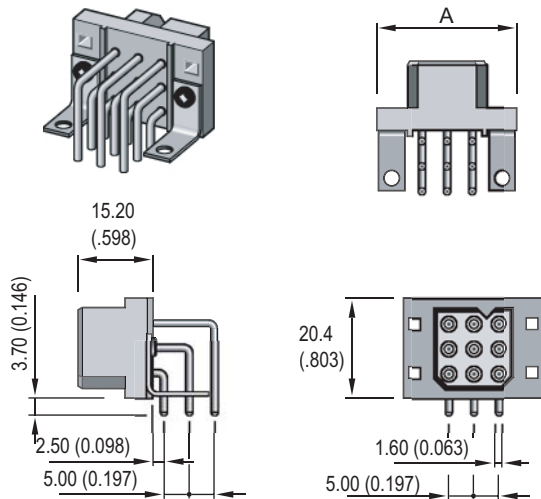

mm (inches)

3 - Row PCB layout for right angle connector

ROWS CONTACTS	A	L1	L2
3 - 09	28.5	10	22.3
3 - 12	33.5	15	27.3
3 - 18	43.5	25	37.3
3 - 24	53.5	35	47.3
3 - 30	63.5	45	57.3

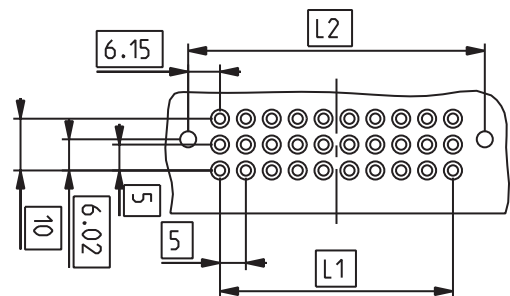

ORDERING INFORMATION

With Latch

Part Number	Description
PM309FR1LOO	3x9 FEMALE Right Angle PCB Solder 3.7mm
PM312FR1LOO	3x12 FEMALE Right Angle PCB Solder 3.7mm
PM318FR1LOO	3x18 FEMALE Right Angle PCB Solder 3.7mm
PM324FR1LOO	3x24 FEMALE Right Angle PCB Solder 3.7mm
PM330FR1LOO	3x30 FEMALE Right Angle PCB Solder 3.7mm

Right Angle PCB Snap Bracket & Latch

Part Number	Description
PM309FR1LSB	3x9 FEMALE Right Angle PCB Solder 3.7mm
PM312FR1LSB	3x12 FEMALE Right Angle PCB Solder 3.7mm
PM318FR1LSB	3x18 FEMALE Right Angle PCB Solder 3.7mm
PM324FR1LSB	3x24 FEMALE Right Angle PCB Solder 3.7mm
PM330FR1LSB	3x30 FEMALE Right Angle PCB Solder 3.7mm

Right Angle PCB Bracket With Hole & Latch

Part Number	Description
PM309FR1LHB	3x9 FEMALE Right Angle PCB Solder 3.7mm
PM312FR1LHB	3x12 FEMALE Right Angle PCB Solder 3.7mm
PM318FR1LHB	3x18 FEMALE Right Angle PCB Solder 3.7mm
PM324FR1LHB	3x24 FEMALE Right Angle PCB Solder 3.7mm
PM330FR1LHB	3x30 FEMALE Right Angle PCB Solder 3.7mm

No Latch

Part Number	Description
PM309FR1OOO	3x9 FEMALE Right Angle PCB Solder 3.7mm
PM312FR1OOO	3x12 FEMALE Right Angle PCB Solder 3.7mm
PM318FR1OOO	3x18 FEMALE Right Angle PCB Solder 3.7mm
PM324FR1OOO	3x24 FEMALE Right Angle PCB Solder 3.7mm
PM330FR1OOO	3x30 FEMALE Right Angle PCB Solder 3.7mm

Right Angle PCB Snap Bracket & No Latch

Part Number	Description
PM309FR1OSB	3x9 FEMALE Right Angle PCB Solder 3.7mm
PM312FR1OSB	3x12 FEMALE Right Angle PCB Solder 3.7mm
PM318FR1OSB	3x18 FEMALE Right Angle PCB Solder 3.7mm
PM324FR1OSB	3x24 FEMALE Right Angle PCB Solder 3.7mm
PM330FR1OSB	3x30 FEMALE Right Angle PCB Solder 3.7mm

Right Angle PCB Bracket With Hole & No Latch

Part Number	Description
PM309FR1OHB	3x9 FEMALE Right Angle PCB Solder 3.7mm
PM312FR1OHB	3x12 FEMALE Right Angle PCB Solder 3.7mm
PM318FR1OHB	3x18 FEMALE Right Angle PCB Solder 3.7mm
PM324FR1OHB	3x24 FEMALE Right Angle PCB Solder 3.7mm
PM330FR1OHB	3x30 FEMALE Right Angle PCB Solder 3.7mm

Three Row Straight PCB (female)

DIMENSIONS

PCB 3 - row straight solder connector

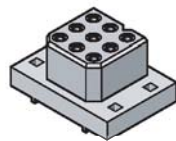
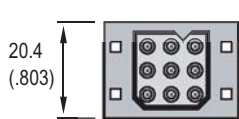
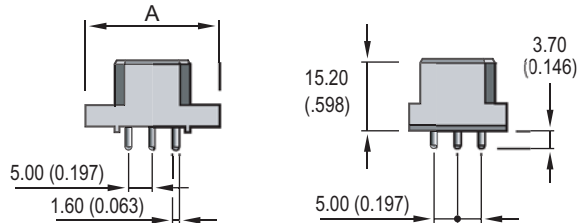

3 - Row PCB layout for straight solder connector

ROWS CONTACTS	A	L1	L2
3 - 09	28.5	10	22.3
3 - 12	33.5	15	27.3
3 - 18	43.5	25	37.3
3 - 24	53.5	35	47.3
3 - 30	63.5	45	57.3

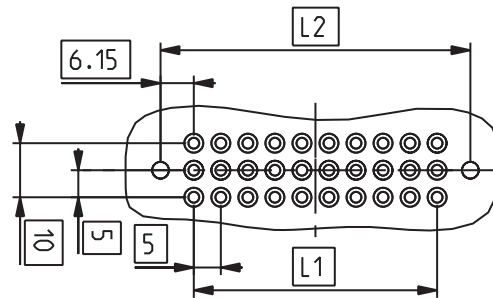

mm (inches)

ORDERING INFORMATION

With Latch

Part Number	Description
PM309FB1LOO	3x9 FEMALE Straight PCB Solder 3.7mm
PM312FB1LOO	3x12 FEMALE Straight PCB Solder 3.7mm
PM318FB1LOO	3x18 FEMALE Straight PCB Solder 3.7mm
PM324FB1LOO	3x24 FEMALE Straight PCB Solder 3.7mm
PM330FB1LOO	3x30 FEMALE Straight PCB Solder 3.7mm

No Latch

Part Number	Description
PM309FB1OOO	3x9 FEMALE Straight PCB Solder 3.7mm
PM312FB1OOO	3x12 FEMALE Straight PCB Solder 3.7mm
PM318FB1OOO	3x18 FEMALE Straight PCB Solder 3.7mm
PM324FB1OOO	3x24 FEMALE Straight PCB Solder 3.7mm
PM330FB1OOO	3x30 FEMALE Straight PCB Solder 3.7mm

Push On PCB Fastener & Latch

Part Number	Description
PM309FB1LSP	3x9 FEMALE Straight PCB Solder 3.7mm
PM312FB1LSP	3x12 FEMALE Straight PCB Solder 3.7mm
PM318FB1LSP	3x18 FEMALE Straight PCB Solder 3.7mm
PM324FB1LSP	3x24 FEMALE Straight PCB Solder 3.7mm
PM330FB1LSP	3x30 FEMALE Straight PCB Solder 3.7mm

Push On PCB Fastener & No Latch

Part Number	Description
PM309FB1OSP	3x9 FEMALE Straight PCB Solder 3.7mm
PM312FB1OSP	3x12 FEMALE Straight PCB Solder 3.7mm
PM318FB1OSP	3x18 FEMALE Straight PCB Solder 3.7mm
PM324FB1OSP	3x24 FEMALE Straight PCB Solder 3.7mm
PM330FB1OSP	3x30 FEMALE Straight PCB Solder 3.7mm

Self-tapping Screws For PCB Mount & Latch

Part Number	Description
PM309FB1LST	3x9 FEMALE Straight PCB Solder 3.7mm
PM312FB1LST	3x12 FEMALE Straight PCB Solder 3.7mm
PM318FB1LST	3x18 FEMALE Straight PCB Solder 3.7mm
PM324FB1LST	3x24 FEMALE Straight PCB Solder 3.7mm
PM330FB1LST	3x30 FEMALE Straight PCB Solder 3.7mm

Self-tapping Screws For PCB Mount & No Latch

Part Number	Description
PM309FB1OST	3x9 FEMALE Straight PCB Solder 3.7mm
PM312FB1OST	3x12 FEMALE Straight PCB Solder 3.7mm
PM318FB1OST	3x18 FEMALE Straight PCB Solder 3.7mm
PM324FB1OST	3x24 FEMALE Straight PCB Solder 3.7mm
PM330FB1OST	3x30 FEMALE Straight PCB Solder 3.7mm